

# PHILIPS **MAGNAVOX**

*FB 209W* Wireless Surround Speaker System

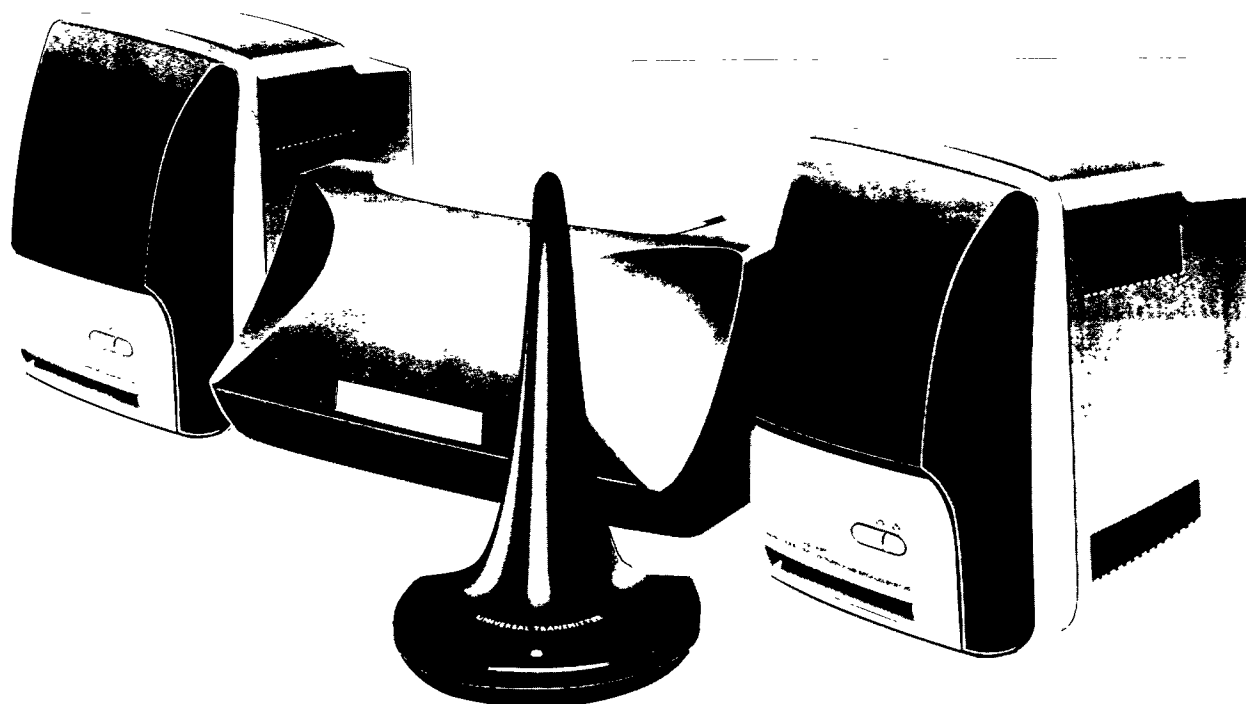

**Toll Free Help Line**  
Ligne d'assistance en service libre  
Línea de ayuda telefónica sin cargo

**800-531-0039**



Owner's Manual  
Mode d'emploi  
Instructivo de manejo

# Return your Warranty Registration card today to ensure you receive all the benefits you're entitled to.

- Once your Philips Magnavox purchase is registered, you're eligible to receive all the privileges of owning a Philips Magnavox product.
- So complete and return the Warranty Registration Card enclosed with your purchase at once. And take advantage of these important benefits.

## Warranty Verification

Registering your product within 10 days confirms your right to maximum protection under the terms and conditions of your Philips Magnavox warranty.

## Owner Confirmation

Your completed Warranty Registration Card serves as verification of ownership in the event of product theft or loss.

## Model Registration

Returning your Warranty Registration Card right away guarantees you'll receive all the information and special offers which you qualify for as the owner of your model.

# PHILIPS MAGNAVOX



**Congratulations on your purchase, and welcome to the "family!"**

Dear Philips Magnavox product owner:

Thank you for your confidence in Philips Magnavox. You've selected one of the best-built, best-backed products available today. And we'll do everything in our power to keep you happy with your purchase for many years to come.

As a member of the Philips Magnavox "family," you're entitled to protection by one of the most comprehensive warranties and outstanding service networks in the industry.

What's more, your purchase guarantees you'll receive all the information and special offers for which you qualify, plus easy access to accessories from our convenient home shopping network.

And most importantly you can count on our uncompromising commitment to your total satisfaction.

All of this is our way of saying welcome—and thanks for investing in a Philips Magnavox product.

Sincerely,

Robert Minkhorst  
President and Chief Executive Officer

**P.S. Remember, to get the most from your Philips Magnavox product, you must return your Warranty Registration Card within 10 days. So please mail it to us right now!**

Know these *safety* symbols



This "bolt of lightning" indicates uninsulated material within your unit may cause an electrical shock. For the safety of everyone in your household, please do not remove product covering.

The "exclamation point" calls attention to features for which you should read the enclosed literature closely to prevent operating and maintenance problems.

**WARNING:** TO PREVENT FIRE OR SHOCK HAZARD, DO NOT EXPOSE THIS EQUIPMENT TO RAIN OR MOISTURE.

**CAUTION:** To prevent electric shock, match wide blade of plug to wide slot, and fully insert.

### For Customer Use

Enter below the Serial No. which is located on the rear of the cabinet. Retain this information for future reference.

Model No. \_\_\_\_\_

Serial No. \_\_\_\_\_

MAC5097

**PHILIPS MAGNAVOX** Visit our World Wide Web Site at <http://www.magnavox.com>

English .....	4	English
Français.....	13	Français
Español .....	23	Español

**México**

**NOM**

Es necesario que lea cuidadosamente su instructivo de manejo.

	<b>PRECAUCIÓN - ADVERTENCIA</b> No abrir, riesgo de choque eléctrico	
	<b>ATENCIÓN</b> Verifique que el voltaje de alimentación sea el requerido para su aparato	
Para evitar el riesgo de choque eléctrico, no quite la tapa. En caso de requerir servicio, dirijase al personal calificado.		

# LIMITED WARRANTY

## AUDIO SYSTEM

One Year Free Labor

One Year Free Service on Parts

This product must be carried in for repair.

### WHO IS COVERED?

You must have proof of purchase to receive warranty service. A sales receipt or other document showing that you purchased the product is considered proof of purchase.

### WHAT IS COVERED?

Warranty coverage begins the day you buy your product. For one year thereafter, all parts will be repaired or replaced, and labor is free. After one year from the day of purchase, you pay for the replacement or repair of all parts, and for all labor charges. All parts, including repaired and replaced parts, are covered only for the original warranty period. When the warranty on the product expires, the warranty on all replaced and repaired parts also expires.

### WHAT IS EXCLUDED?

Your warranty does not cover:

- labor charges for installation or setup of the product, adjustment of customer controls on the product, and installation or repair of antenna systems outside of the product.
- product repair and/or part replacement because of misuse, accident, unauthorized repair or other cause not within the control of Philips Consumer Electronics Company.
- reception problems caused by signal conditions or cable or antenna systems outside the unit.
- a product that requires modification or adaptation to enable it to operate in any country other than the country for which it was designed, manufactured, approved and/or authorized, or repair of products damaged by these modifications.
- incidental or consequential damages resulting from the product. (Some states do not allow the exclusion of incidental or consequential damages, so the above exclusion may not apply to you. This includes, but is not limited to, prerecorded material, whether copyrighted or not copyrighted.)
- a product that is used for commercial or institutional purposes.

### WHERE IS SERVICE AVAILABLE?

Warranty service is available in all countries where the product is officially distributed by Philips Consumer Electronics Company. In countries where Philips Consumer Electronics Company does not distribute the product, the local Philips service organization will attempt to provide service (although there may be a delay if the appropriate spare parts and technical manual(s) are not readily available).

### MAKE SURE YOU KEEP...

Please keep your sales receipt or other document showing proof of purchase. Attach it to this owner's manual and keep both nearby. Also keep the original box and packing material in case you need to return your product.

### BEFORE REQUESTING SERVICE...

Please check your owner's manual before requesting service. Adjustments of the controls discussed there may save you a service call.

### TO GET WARRANTY SERVICE IN U.S.A., PUERTO RICO OR U.S. VIRGIN ISLANDS...

Take the product to a Philips factory service center (see enclosed list) or authorized service center for repair. When the product has been repaired, you must pick up the unit at the center. Centers may keep defective parts. (In U.S.A., Puerto Rico and U.S. Virgin Islands, all implied warranties, including implied warranties of merchantability and fitness for a particular purpose, are limited in duration to the duration of this express warranty. But, because some states do not allow limitations on how long an implied warranty may last, this limitation may not apply to you.)

### TO GET WARRANTY SERVICE IN CANADA...

Please contact Philips at:

1-800-661-6162 (French Speaking)

1-800-363-7278 (English Speaking)

(In Canada, this warranty is given in lieu of all other warranties. No other warranties are expressed or implied, including any implied warranties of merchantability or fitness for a particular purpose. Philips is not liable under any circumstances for any direct, indirect, special, incidental or consequential damages, howsoever incurred, even if notified of the possibility of such damages.)

### REMEMBER...

Please record the model and serial numbers found on the product below. Also, please fill out and mail your warranty registration card promptly. It will be easier for us to notify you if necessary.

MODEL # \_\_\_\_\_

SERIAL # \_\_\_\_\_

*This warranty gives you specific legal rights. You may have other rights which vary from state/province to state/province.*

Philips Service Company, P.O. Box 555, Jefferson City, Tennessee 37760, (423) 475-8869

EL4965E004 / MAC 4110 / 1-97

# SAFETY INSTRUCTIONS – Read before operating equipment

This product was designed and manufactured to meet strict quality and safety standards. There are, however, some installation and operation precautions which you should be particularly aware of.

1. **Read Instructions** - All the safety and operating instructions should be read before the appliance is operated.
2. **Retain Instructions** - The safety and operating instructions should be retained for future reference.
3. **Heed Warnings** - All warnings on the appliance and in the operating instructions should be adhered to.
4. **Follow Instructions** - All operating and use instructions should be followed.
5. **Water and Moisture** - The appliance should not be used near water - for example, near a bathtub, washbowl, kitchen sink, laundry tub, in a wet basement or near a swimming pool, etc.
6. **Carts and Stands** - The appliance should be used only with a cart or stand that is recommended by the manufacturer.
- 6A.  An appliance and cart combination should be moved with care. Quick stops, excessive force, and uneven surfaces may cause the appliance and cart combination to overturn.
7. **Wall or Ceiling Mounting** - The appliance should be mounted to a wall or ceiling only as recommended by the manufacturer.
8. **Ventilation** - The appliance should be situated so that its location or position does not interfere with its proper ventilation. For example, the appliance should not be situated on a bed, sofa, rug, or similar surface that may block the ventilation openings; or, placed in a built-in installation, such as a bookcase or cabinet that may impede the flow of air through the ventilation openings.
9. **Heat** - The appliance should be situated away from heat sources such as radiators, heat registers, stoves, or other appliances (including amplifiers) that produce heat.
10. **Power Sources** - The appliance should be connected to a power supply only of the type described in the operating instructions or as marked on the appliance.

11. **Grounding or Polarization** - Precautions should be taken so that the grounding or polarization means of an appliance is not defeated.

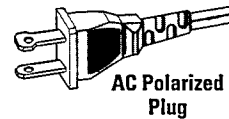

**CAUTION:** To prevent electric shock, match the wide blade of this plug to the wide slot, fully insert. Do not use this (polarized) plug with an extension cord, receptacle or other outlet unless the blades can be fully inserted to prevent blade exposure.

12. **Power-Cord Protection** - Power supply cords should be routed so that they are not likely to be walked on or pinched by items placed upon or against them, paying particular attention to cords and plugs, convenience receptacles, and the point where they exit from the appliance.
13. **Cleaning** - The appliance should be cleaned only as recommended by the manufacturer.
14. **Power Lines** - An outdoor antenna should be located away from power lines.
15. **Nonuse Periods** - The power cord of the appliance should be unplugged from the outlet when left unused for a long period of time.
16. **Object and Liquid Entry** - Care should be taken so that objects do not fall and liquids are not spilled into the enclosure through openings.
17. **Damage Requiring Service** - The appliance should be serviced by qualified service personnel when:
  - A. The power-supply cord or the plug has been damaged; or
  - B. Objects have fallen, or liquid has spilled into the appliance; or
  - C. The appliance has been exposed to rain; or
  - D. The appliance does not appear to operate normally or exhibits a marked change in performance; or
  - E. The appliance has been dropped, or the enclosure damaged.
18. **Servicing** - The user should not attempt to service the appliance beyond that described in the operating instructions. All other servicing should be referred to qualified service personnel.

English

EL 4562-1: 91/8

# EQUIPMENT SUPPLIED

English

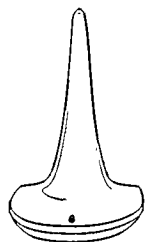

Transmitter

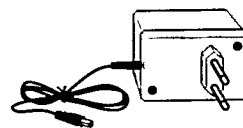

AC/DC adapter

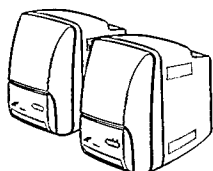

2 Surround speakers

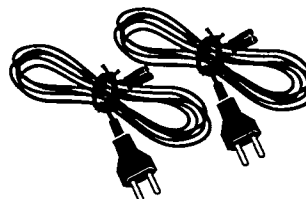

2 power cables for speaker

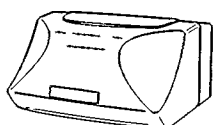

Center speaker

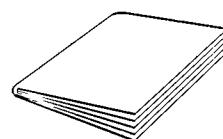

Instructions for use

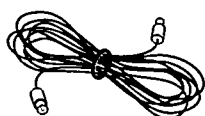

Cinch cable

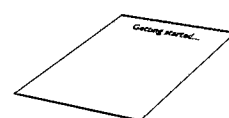

"Getting Wireless" card

## ***Environmental information***

All redundant packing material has been omitted. We have done our utmost to make the packaging easy separable into three mono materials: cardboard (box), polystyrene foam (buffer) and polyethylene (bags, protective foam sheet).

Your set consists of material which can be recycled if disassembled by a specialized company. Please observe the local regulations regarding the disposal of packing materials, exhausted batteries and old equipment.

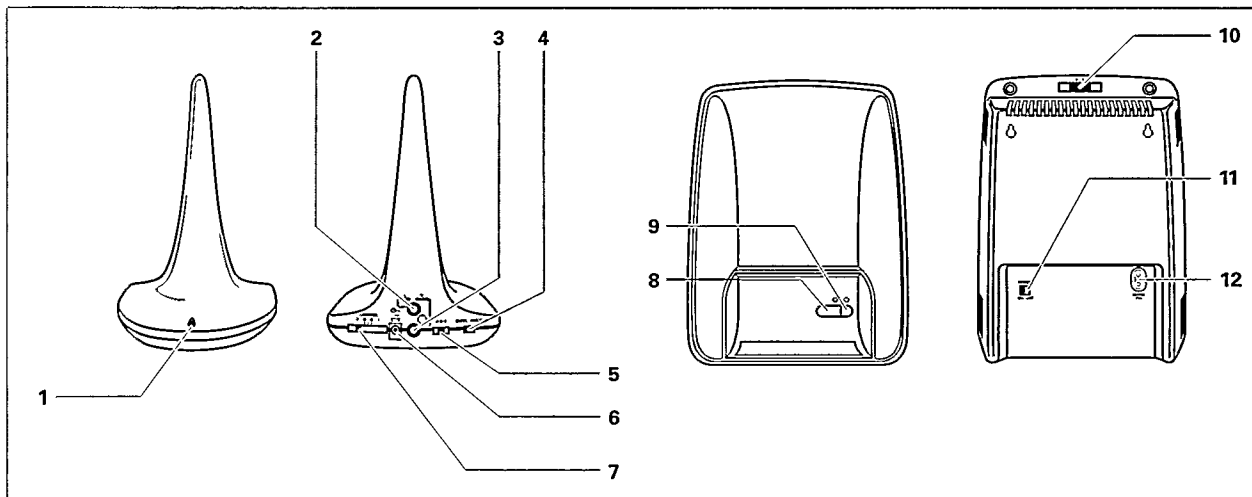

### Transmitter

- 1 Status light.....**RED:** Transmitter is on.  
**BLINKING:** Transmitter is on and input level is too high (see 5).  
**OFF:** Transmitter is in standby mode or is not connected to the AC/DC adapter.
- 2 L (SUB).....Not used with the supplied configuration.
- 3 R (SURR).....To connect the transmitter unit to the SURROUND OUT (SURR PRE OUT) jack of your set.
- 4 SURR / MULTI.....Set this selector to SURR, the position MULTI is not used with the supplied configuration.
- 5 A-B-C.....To set the input sensitivity of the transmitter unit.  
**A:** maximum sensitivity  
**B:** medium sensitivity  
**C:** minimum sensitivity
- 6 14 V.....Connect the provided AC/DC adapter here.
- 7 CHANNEL.....7 step channel selector for setting the channel in case of interferences.

*Note:* – Always be sure that the transmitter unit and the active surround speaker are switched to the same channel, otherwise no sound or only a distorted sound will be heard on the surround speakers.

- Cellular phones used near the system (1–2 meters) may interfere with the transmission.
- You have to switch off the active surround speaker before setting the transmitting channel.

### Active surround speakers

- 8 .....**GREEN LIGHT:** If this is on, the active speaker is on.
  - 9 .....**RED LIGHT:** If this is on, the active speaker is in standby mode.
- Note:* – If both lights are off the active speaker is switched off or is not connected to a power source.
- 10 CHANNEL.....7 step channel selector for setting the channel in case of interferences.
  - 11 POWER.....To switch the active surround speaker on and off.
  - 12 MAINS.....To connect the active surround speaker to the power source.

**The set complies with the FCC-Rules, Part 15. Operation is subject to the following two conditions:**

- 1. This device may not cause harmful interference, and**
- 2. This device must accept any interference received, including interference that may cause undesired operation.**

# CONNECTIONS

English

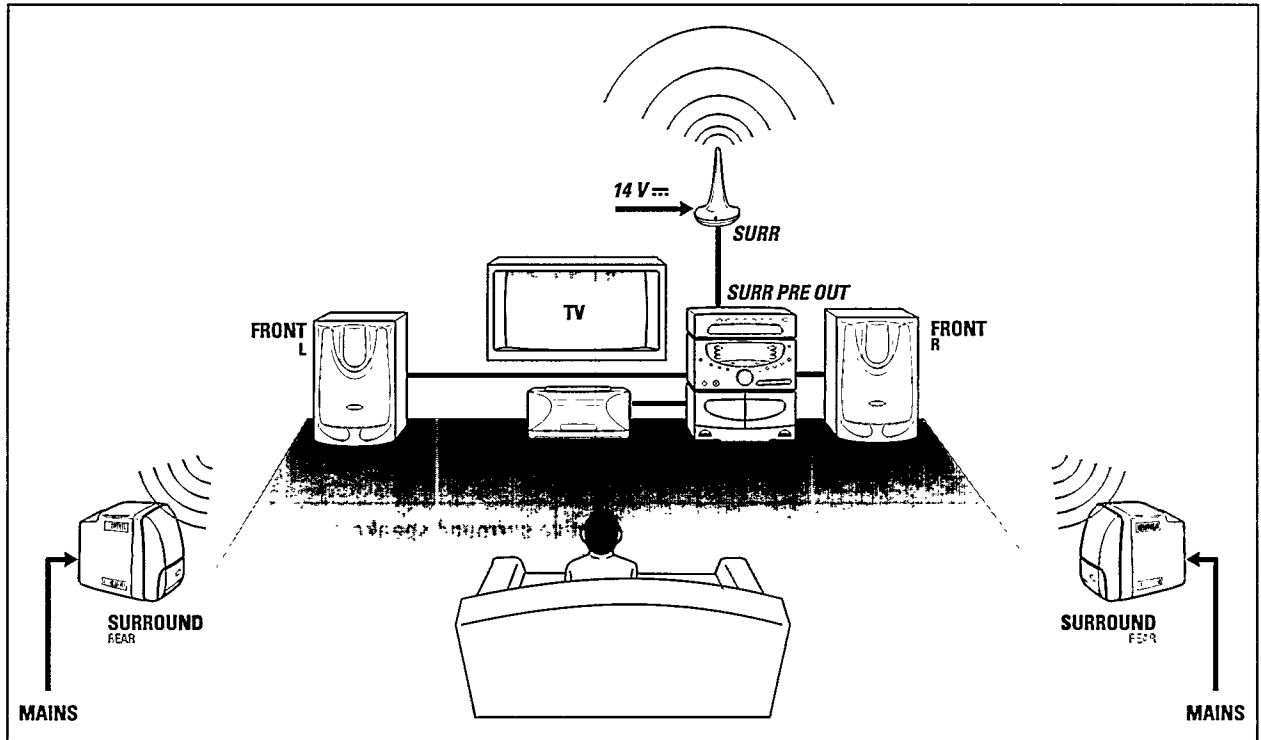

### Important!

**Always switch off all your equipment before making any connections!**

To connect your wireless speaker system, refer to the picture above.

The speaker connections on the appliance may be screw connectors or click-fit connectors.

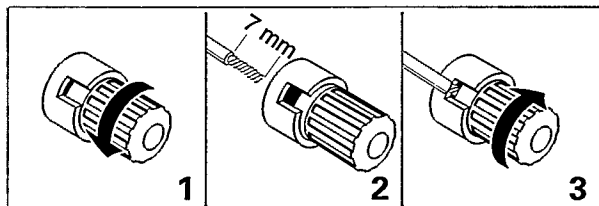
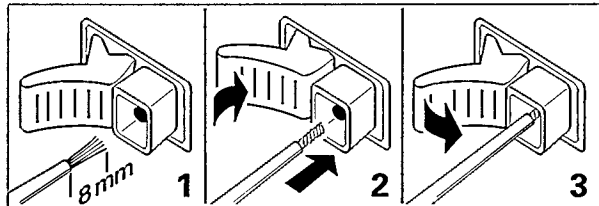

At the rear of the appliance you will find a colored or ⊕ terminal and a black or ⊖ terminal for each speaker.

*Note: – After connecting all the speakers, do not forget to adjust the relative sound level between them.*

### Front speakers (not included) and center speaker

Connect the colored speaker wire to the coloured or ⊕ terminal, and the black wire to the black or ⊖ terminal of the appliance.

### Surround speakers

Connect the active speakers to the power source with the power cable provided. Switch on the active speaker with the POWER switch.

### Transmitter unit

Connect the SURRE terminal of the transmitter with the PRE OUT (SURROUND) terminal of the appliance using the supplied cinch cable. Connect the AC/DC adapter supplied to the 14 V socket of the transmitter. Then connect the AC/DC adapter to the power source.

*Note: – The SUB terminal of the transmitter is not used with this set.*



**Positioning of the transmitter**

Position the unit in a way that you are able to "see" the active surround speaker from the position of the unit.

To avoid sound distortions caused by magnetic fields do not place the transmitter on your TV set.

**Positioning of the speakers**

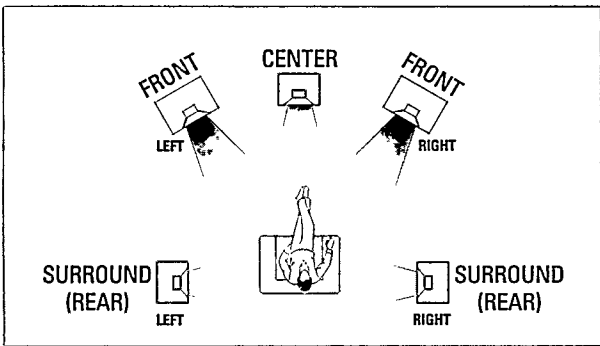

**Important!**  
To avoid overheating do not cover any vents and leave a minimum distance of 5 centimeters (2 inches) for ventilation.

**General hints for positioning**  
Avoid positioning the speakers in a corner or on the floor, as this will boost the bass tones too much. Placing the speakers behind curtains, furniture etc. will reduce the treble response, thus reducing the stereo effect considerably. The listener should always be able to "see" the speakers.

Each room has different acoustic characteristics and the positioning possibilities are often limited. You can find the best position for your speakers by following the picture above. The speakers should always be arranged as symmetrically as possible in the room.

**Positioning the center speaker**  
The center speaker should be placed in the center between both front speakers, e. g. underneath or on top of the TV. The best height for the center speaker is at the height of the listener's ears (while seated).

**Positioning the surround speakers**  
The surround speakers should face each other and be in line with, or at most 1.5m (4ft 6ins) behind the listener.

**Adjusting the relative sound level**

After installing your speakers, you will have to find a good sound balance between the surround, center and front speakers.

In the instruction booklet of your appliance you will find a section describing how to adjust the sound of the different speakers. Follow those instructions to get the most out of your new speakers.

**Setting the input sensitivity A-B-C**

Depending on which sound source you use, the signals delivered have different strengths.

If the red light on the front of the transmitter unit **starts to blink**, the incoming signal is too strong. This will cause distortions. Set the A-B-C switch to adjust the input sensitivity to a lower level. If the red light on the front of the transmitter unit **goes off** during play, the incoming signal is not strong enough. Set the A-B-C switch to adjust the input sensitivity to a higher level.

**Setting the transmitting channel**

In case of signal interference from the transmitter it is possible to change to another transmitting channel.

- 1 Switch off **both** active surround speakers.
- 2 Set the CHANNEL slide at the back of the transmitter to another number.
- 3 Set the CHANNEL slide at the back of **both** active surround speakers to the same number as on the transmitter.
- 4 Switch on **both** active surround speakers.

*Note: – Always be sure that the transmitter and the active surround speakers are switched to the same transmitting channel, otherwise no sound or only a distorted sound will be heard on the surround speakers.*

**Switching On-Standby-Off**

The transmitter is equipped with a sensitive input. If there is no signal on the SUB and SURR input the transmitter and the surround speakers will switch to standby after approximately 100 seconds.

The green light on the front of the active surround speakers shows that the speakers are on. If the red light is on, the speakers has switched to standby. To switch the active speakers off, use the POWER switch.

If the red light on the front of the transmitter is off, it has switched to standby. To switch the transmitter off, unplug the AC/DC adapter from the power source.

**Power handling**

Any amplifier or receiver used at high power can produce distortions which may seriously damage your speakers. If distortion occurs, reduce the volume and the tone control to a level where the sound is acceptable again.

When using microphones, avoid feedback which occurs when a microphone picks up sound from the speakers, resulting in a howling noise. Keep the microphone away from the speakers or reduce the volume.

**Maintenance**

A chamois leather slightly moistened with water is sufficient for cleaning the speaker cabinet. Do not use cleaning agents containing alcohol, spirits, ammonia or abrasives.

Do not leave the speakers for a long time in direct sunlight or other places where high temperatures can occur.

Do not expose the speakers to humidity or rain.

**More wireless products...**

The transmitter is also equipped to drive an optional wireless subwoofer, wireless stereo speakers or wireless headphones.

Please ask your dealer about these products. Refer to the instructions provided with these products before using them with your transmitter.

**Technical data**

Subject to change without notice

**Surround speakers**

Impedance .....3Ω  
 Frequency range .....100–15,000Hz  
 Output power .....2 × 22 W RMS/3Ω/1kHz/THD 10%  
 Sensitivity .....87dB  
 Drivers .....1 × 4" full range  
 Dimensions (h × w × d) .....219 × 174 × 209mm  
 Weight .....approx. 3kg  
 \* ±1 dB

**Magnetically shielded center speaker**

Impedance .....12Ω  
 Frequency range .....75–20,000Hz  
 Power handling capacity .....50W  
 Sensitivity .....89dB  
 Drivers .....2 × 4" woofers, 1 × 1 ¼" tweeter  
 Crossover frequencies .....8,000Hz  
 Dimensions (h × w × d) .....152 × 400 × 160mm  
 Weight .....approx. 3.4kg

**Transmitter**

System .....Radio frequency (RF)  
 Modulation .....Frequency modulation (FM)  
 S/N in signal .....95dB  
 Step channel frequency .....913.750–915.250MHz  
 Transmission power .....< 10mW  
 Working range .....up to 100m  
 Dimensions (h × w × d) .....206 × 130 × 134mm  
 Weight .....approx. 0.26kg

## WARNING

*Under no circumstances should you try to repair the speakers yourself, as this will invalidate the warranty.*

If a fault occurs, first check the points listed below before taking the speakers for repair.

If you are unable to solve a problem by following these hints, consult your dealer or service center.

PROBLEM	POSSIBLE CAUSE	SOLUTION
<b>No sound</b>	VOLUME is not correctly adjusted.	Adjust the VOLUME.
	Headphones are connected to the appliance.	Disconnect headphones.
	Speakers are not (or wrongly) connected.	Connect the speakers securely.
<b>No sound on the left or right side</b>	One speaker is wrongly connected.	Connect the speaker properly.
	A speaker cable is damaged.	Replace the cable.
<b>Poor sound or no sound at the center or surround speakers</b>	SURROUND mode is not switched on.	Switch to the surround mode on the appliance.
	Surround and/or center speakers are not (properly) connected.	Connect the speakers properly.
	A speaker cable is damaged.	Replace the cable.
	Transmitter or active surround speakers are switched off.	Switch on transmitter and active surround speakers.
	Transmitter and/or active surround speakers are not securely connected to the power source.	Connect the power cables properly.
	CHANNEL slides of the transmitter and the active speakers are not switched to the same number.	Set the CHANNEL slides on the transmitter and on <b>both</b> active speakers to the same number.
	Transmitter is connected to the wrong terminal on the appliance.	Connect the transmitter to the correct terminal on the appliance.
	SURR/MULTI switch of the transmitter is in the wrong position.	Set the SURR/MULTI switch to the SURR position.
	The signal from the transmitter is interfered through electric appliances.	Set the transmitter and the active surround speakers to another transmitting channel.
The signal from your appliance is too strong.	Set the input sensitivity of the transmitter to the next level.	
<b>Poor bass sound</b>	Speakers are not in phase.	Connect speakers properly; colored cable to ⊕-pole, black cable to ⊖-pole.
<b>Bad sound</b>	Setting does not match for the given type of music or sound.	Correct the sound settings on the appliance.
<b>Surround sound level is too low or too high</b>	The level of the surround sound is not properly adjusted.	Adjust the level and delay time of the surround sound on the appliance.
<b>Center sound level is too low or too high</b>	The sound level of the center channel is not properly adjusted.	Adjust the level of the center channel on the appliance.



English

Français

Español

# PHILIPS CONSUMER ELECTRONICS COMPANY

A Division of Philips Electronics North America Corporation  
Knoxville, Tennessee 37914-1810, U.S.A.

